

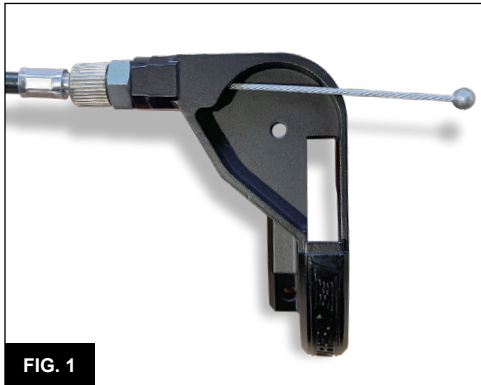

MOTION PRO, INC.
3171 Swetzer Road
Loomis, CA 95650
Tel 650.594.9600 Fax 650.594.9610
www.motionpro.com

INSTRUCTIONS

MOTION PRO Turbo™ SE Throttle P/N 01-2813

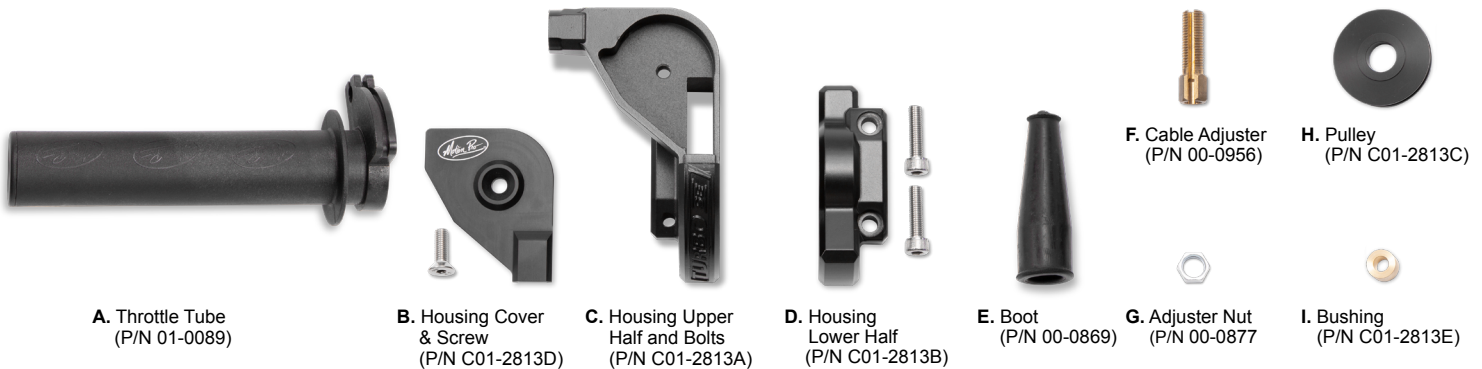

1. For optimal performance, lubricate throttle cable before installing the throttle. We recommend using Motion Pro Cable Lube part no. 15-0002 and Cable Luber V3 part no. 08-0609.

2. Before installing the new throttle housing, clean the throttle side of the handle bar and inspect for any damage.

3. Remove housing cover screw (B), housing cover (B), pulley (H) and bushing (I).

4. Remove mounting screws and separate the top and bottom halves of the housing (C and D) and remove the throttle tube (A).

5. Install the cable into the upper throttle housing (C), run the cable adjuster (F) all the way into the housing until it bottoms out. This will give you the maximum amount of free length on the inner wire and make assembly easier (**Fig.1**).

6. The throttle tube (A) supplied with this kit has a removable pop out end. If you are running wrap around style hand protectors you can remove the end cap on the throttle tube by inserting a socket into the tube and with a light tap the end cap will pop off.

7. Install throttle tube (A) onto the handle bar and place the upper housing (C) over the throttle tube (A) (**Fig.2**).

8. Place a small amount of grease onto the fitting on the inner wire of the cable and insert cable through the hole in the upper housing, then insert the ball into the throttle tube (**Fig.2**).

9. Attach the lower housing with the two 5mm mounting screws and tighten to 4nm (36 in LBS).

10. Insert the pulley and bushing into the top housing. Make sure the inner wire is seated inside the center groove on the pulley and install the top cover (**Fig.3**).

11. Adjust cable free play as described in your OEM service manual. There should always be a small amount of free play in the cable so that the throttle is not held open.

12. Install supplied Motion Pro grips as per the instructions. We recommend using Motion Pro Grip Glue part no.15-0003.

IMPORTANT: Before starting your vehicle, first test the throttle function with the engine off. Make sure the throttle closes completely when the throttle is released and check that the cable and throttle are operating smoothly with no stickiness. Then make sure vehicle is in neutral, start engine, and make sure throttle operates smoothly, closes completely, and that engine RPM does not increase when handlebars are turned in each direction to full range of movement.

WARNING: FAILURE TO INSTALL THESE COMPONENTS CORRECTLY MAY RESULT IN GREAT BODILY INJURY OR DEATH. INSTALLATION SHOULD BE PERFORMED BY A PROFESSIONAL TECHNICIAN. FOLLOW ALL OEM PROCEDURES AND TORQUE VALUES AS OUTLINED IN THE FACTORY SERVICE MANUAL.

