



Motion Pro, Inc.
 3171 Swetzer Rd.
 Loomis, CA 95650
 Tel: 650.594.9600 Fax: 650.594.9610
 www.motionpro.com

INSTRUCTIONS

MOTION PRO FUEL INJECTOR CLEANING KIT

P/N 08-0592, 08-0593, 08-0594, 08-0595,
 08-0615, 08-0639

Read all instructions and Warning at end of instructions before attempting to use this tool!

FI PIGTAIL CONNECTORS AVAILABLE FOR PURCHASE SEPERATELY



P/N 08-0596



P/N 08-0597



P/N 08-0598



P/N 08-0599



P/N 08-0616



P/N 08-0637

The Motion Pro Fuel Injector Cleaner is designed to flush out and clean debris and deposits inside the fuel injector. Because there are many different styles and brands of injectors the instructions below should be used as a guideline to illustrate the intended use of this tool.

FLUSHING FUEL INJECTOR

Step 1:

Insert the engine side of the injector into the tool as shown in **Fig 1**. For this operation the injector will be inserted into Port 2, however some style injectors may need to be placed into Port 1.

Turn the electrical connector on the fuel injector toward the outside of the tool as shown in **Fig 2**. Install the hold-down clamp as shown in **Fig 2**, being careful not to damage the O-rings. Carefully tighten screws sufficiently to compress the lower seal on the injector. **Warning: DO NOT OVER TIGHTEN THE SCREWS or you will damage the injector!**

Install the electrical connector to both the injector and the tool with the appropriate pigtail for your injector (**Fig 3**). You should hear a click when the red button is pushed. This will open the solenoid inside the injector and allow the cleaning fluid to pass through.

Loosen the red knob opposite the port that the injector is set in. Insert the tube from the aerosol can of injector cleaner or carb cleaner into the bottom of the tool as shown in **Fig 4**. Tighten the red knob to lightly seal the tube to the injector cleaner.

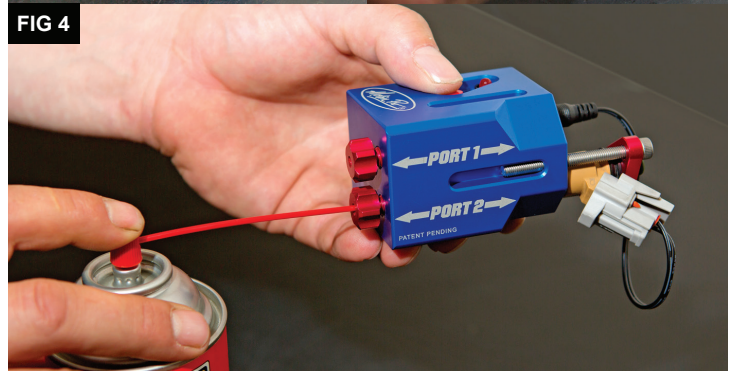
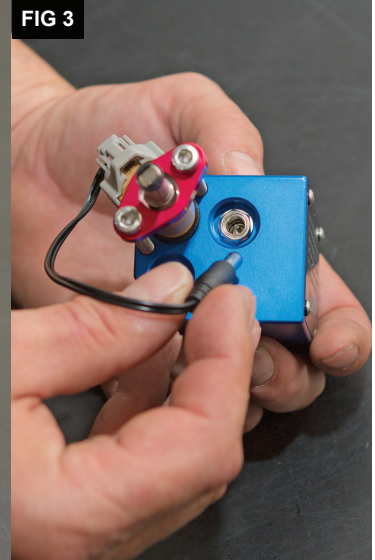
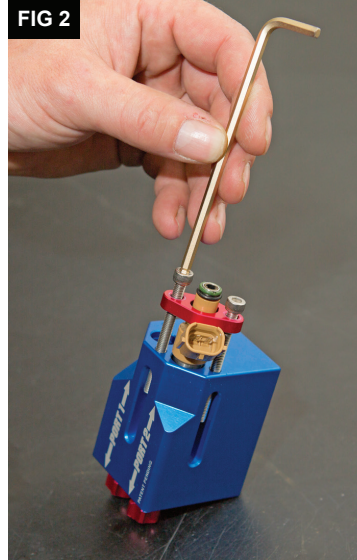
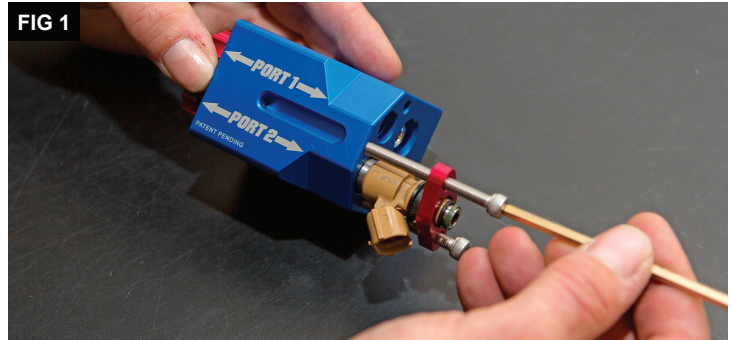

Press the red button to activate the fuel injector and flush (Fig 5). Note that you will NOT see any spray pattern. This step is to back flush the injector and remove any dirt or debris that may accumulate in the injector. Remove the injector and proceed to Step 2.

CLEANING FUEL INJECTOR

STEP 2:

Remove the lower compression seal on the injector so that it does not get damaged by the clamp and install the fuel side of the injector into the tool (Fig 6 & 7). For this operation the injector will be inserted into Port 1, however some style injectors may need to be placed into Port 2.

Install the clamp and the electrical connector as shown in step 1, being careful not to damage the O-rings. Again, **DO NOT OVER TIGHTEN THE SCREWS.**

Loosen red knob on the port opposite the fuel injector and insert the tube from the aerosol can into the bottom of the tool as shown in Fig 8. Tighten the red knob to seal the tube to the injector cleaner as before.

Press the red button to activate the injector and clean as shown in (Fig 8).

WARNING!

Cleaning fuel injectors should be done by a trained mechanic, following procedures set out in the vehicle's factory service manual. Follow instructions in the factory service manual for removal and installation of fuel injector. This tool is designed for use with commonly available fuel injector cleaning fluids only. Read warning labels and directions for use on cleaning fluid container before use. Make sure you have adequate ventilation and do not inhale cleaning fluid or fumes. Always wear safety glasses when using this tool! Most fuel injector cleaner fluid is highly flammable. Wear appropriate clothing, do not use near open flame, and do not smoke when using this tool. Improper use of this tool could damage your fuel injector and/or could cause great bodily injury or death.

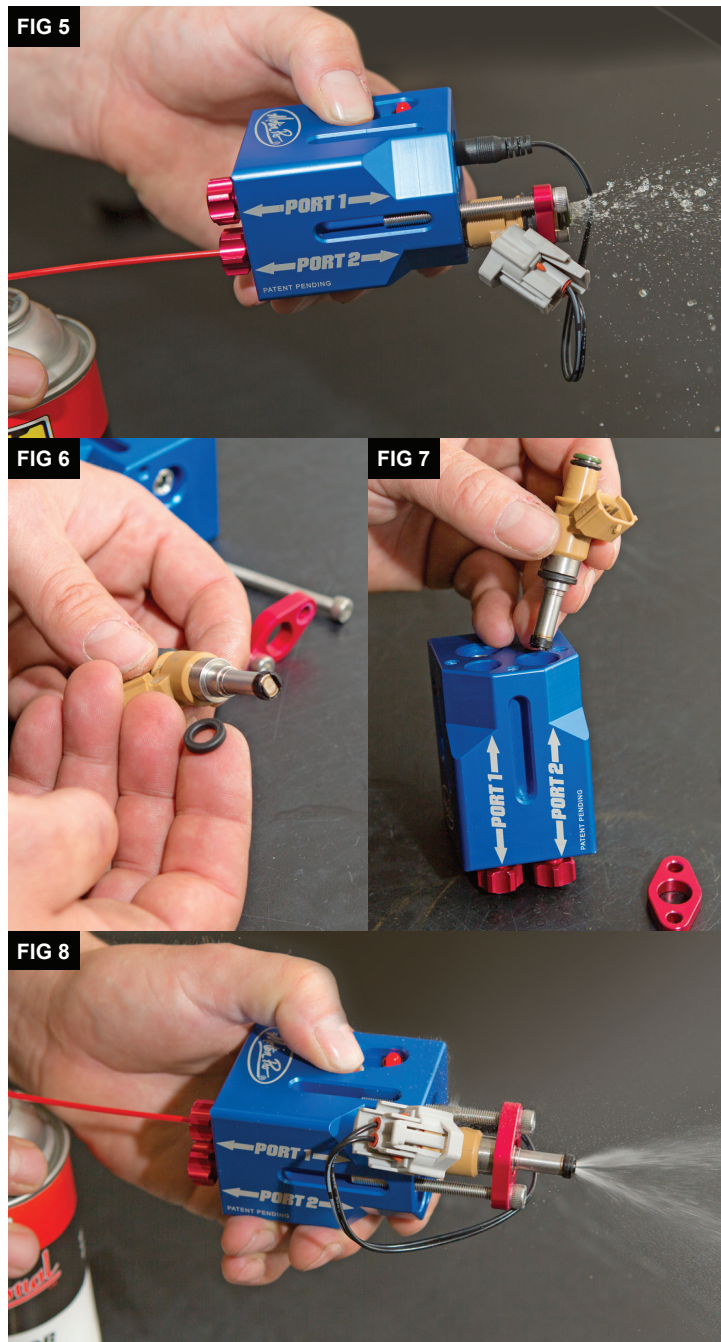

BATTERY INDICATOR LED

The LED on the body of the tool will light when the button is pressed. A battery in new condition will light the LED very brightly. As the charge in the battery drops, the LED will dim. A battery without enough power to cycle the solenoid will not light the LED. A typical brand name battery should be able to clean 100+ injectors during its life span.

BATTERY REPLACEMENT

To access the battery, you will need a 2 mm hex key to remove the bolts from the side plate. Caution: Carefully unsnap the battery from the connector, pulling too hard may cause damage to the connector.

